

Opening angle

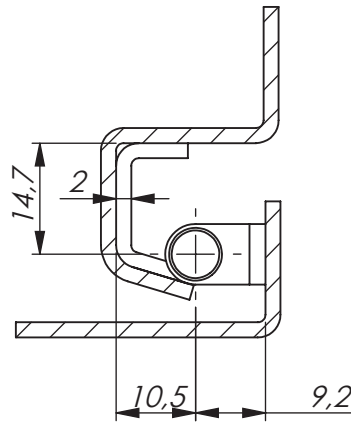

Universal LH / RH



Specifications subject to change without notice

## STAINLESS CONCEALED HINGE - 120° OPENING ANGLE

Stainless concealed hinge. Frame part for screws or weld-on mounting. Door part with welding warts for press welding. Opening angle 120°. Universal left and right mounting.

Steel version: Page 3-045.

**MATERIAL:**

Stainless steel (304).

STAINLESS CONCEALED HINGE - 120° OPENING ANGLE	
P/N	Description
313018	Stainless concealed hinge