





-  For cam
-  With cylinder
-  IP65 Protection degree
-  90° Handle rotation
-  Universal LH / RH



FLUSH SWING HANDLE

Flush swing handle with locking cylinder for cam. Extra thin design.
Key extraction: Open/closed.

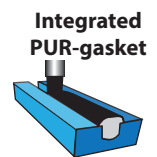
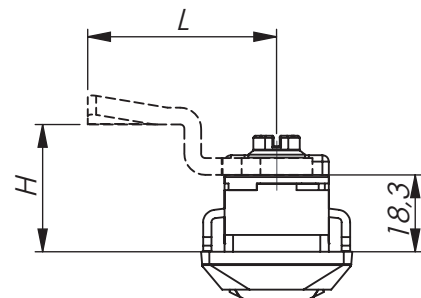
Cams: Page 2-480, 2-490 and 2-510.
Rods: Page 2-540, 2-541 and 2-545.
Rod guides: Page 2-560 and 2-570.
Cut-out version E: Page 1-001.02.

MATERIAL:

Handle: Zinc die cast, black powder coated.
Dish: Glass fibre reinforced polyamide (PA6), black.
Shaft: Zinc die-cast, zinc plated.
Cylinder: Zinc die-cast, stainless steel (304) cap and dust shutter.

FLUSH SWING HANDLE	
P/N	Description
105002-2	Swing handle - keyed alike IL0333

Specifications subject to change without notice