

Spring hinges

Spring force in N.m :

M(0°) : 0,09 N.m / M(90°) : 0,07 N.m / M(180°) : 0,045 N.m



A	B	C	D	F	G	S1	S2	note	part number	material	finish	weight
60	35	1	3	7.5	35	3.1	5	stainless steel opening spring	71-1-3560	430 stainless steel	raw	22g

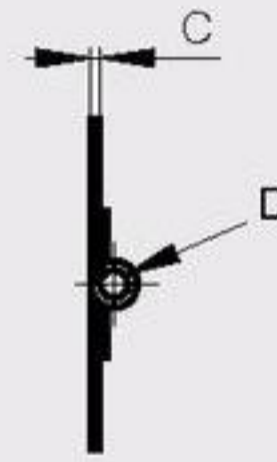
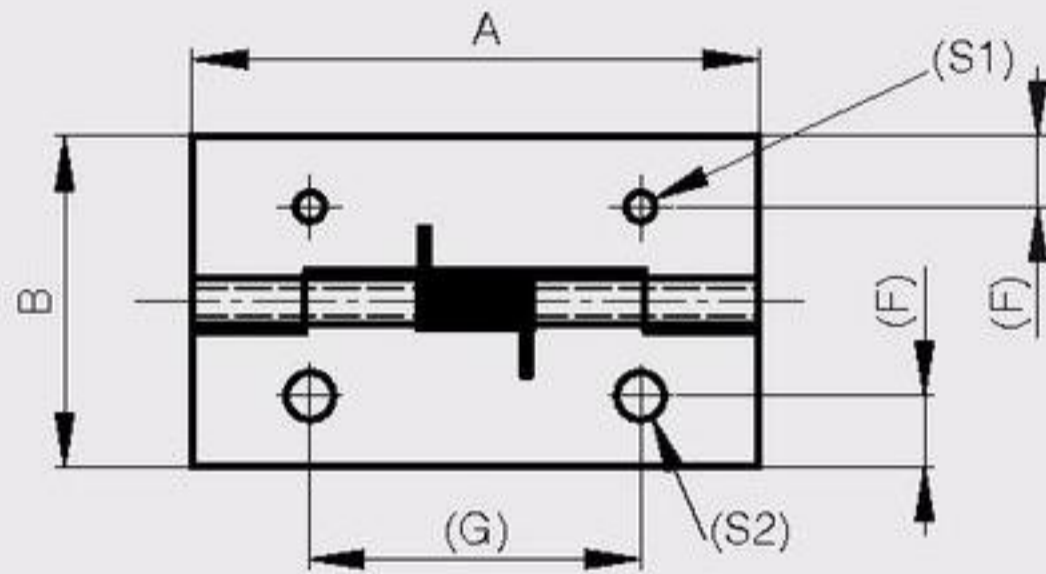

Spring force in N.m :

M(0°) : 0,12 N.m / M(90°) : 0,09 N.m / M(180°) : 0,06 N.m



A	B	C	D	F	G	S	note	part number	material	finish	weight
75	20	0.8	1.8	11.2	60	2.8	stainless steel opening spring	71-1-3305	steel	raw	11.5g
75	20	0.8	1.8	11.2	60	2.8	stainless steel opening spring	71-1-3582	304 stainless steel	raw	11.5g

