

### Adjustable toggle latch with strike

Dimension A is adjustable / 60mm to 65mm

A	B	C	note	part number	material	finish	weight
60	22	10	60<A<65	16-7-3839	steel	zinc plated	36g

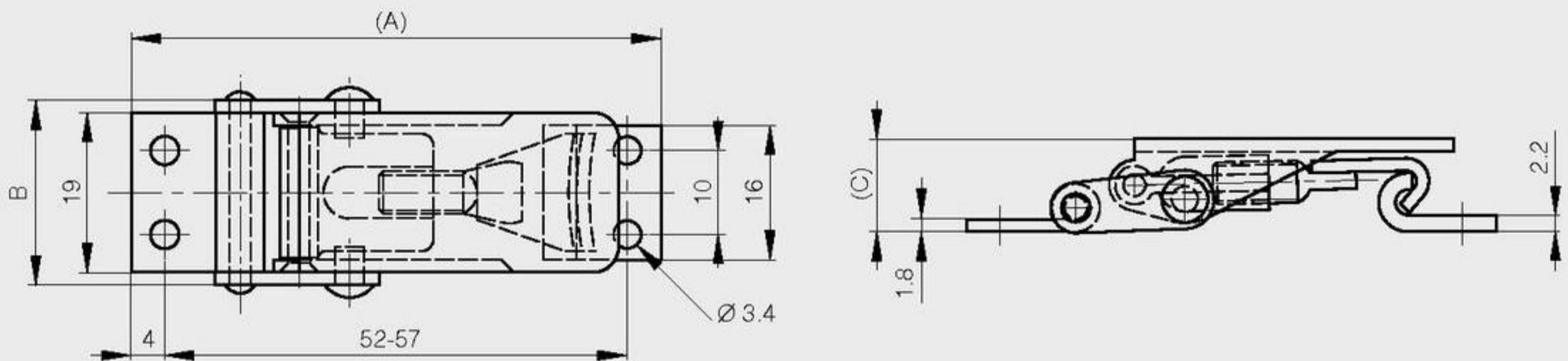

### Adjustable toggle latches without strike

This latch is used with strike part numbers 16-7-3939 and 16-7-3940 (see below)  
 Part number 16-7-3934 has a lockable nut.

A	B	C	part number	material	finish	weight
70.6	28.2	16	16-7-3932	steel	zinc plated	50g
70.6	28.2	16	16-7-3934	steel	zinc plated	50g
70.6	28.2	16	16-7-3933	304 stainless steel	raw	50g

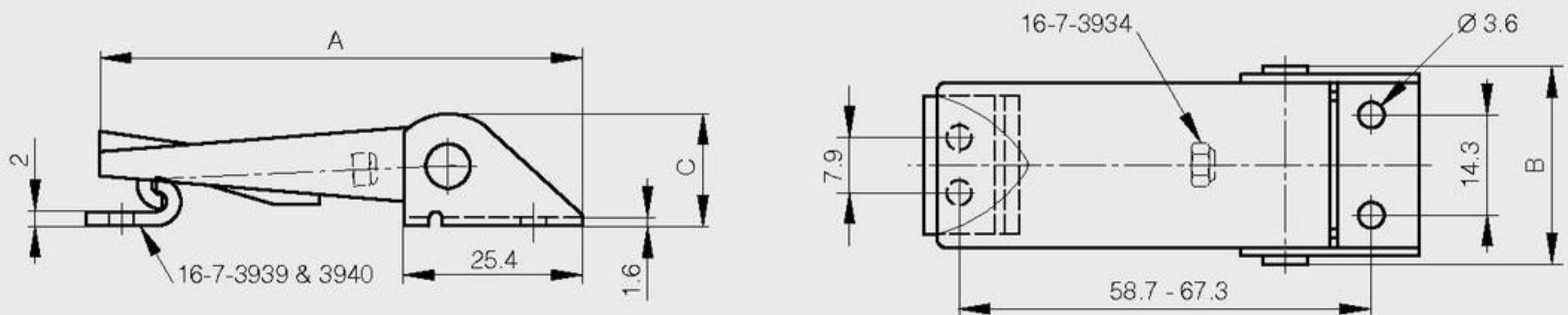

### Strike for part numbers 16-7-3932, 16-7-3933 and 16-7-3934

part number	material	finish	weight
16-7-3939	steel	zinc plated	4.5g
16-7-3940	304 stainless steel	raw	4.5g

