

4-355 Hinge Pr01 180°

for nested door



Screw-on Hinge for flush doors,
with PA bushings.

- RH or LH application.

Material:

- **Frame part:**
zinc die, zinc plated
- **Door part:**
steel, zinc plated
- **Pin:**
steel, zinc plated
- **Bushings:**
PA, natural



Example of application

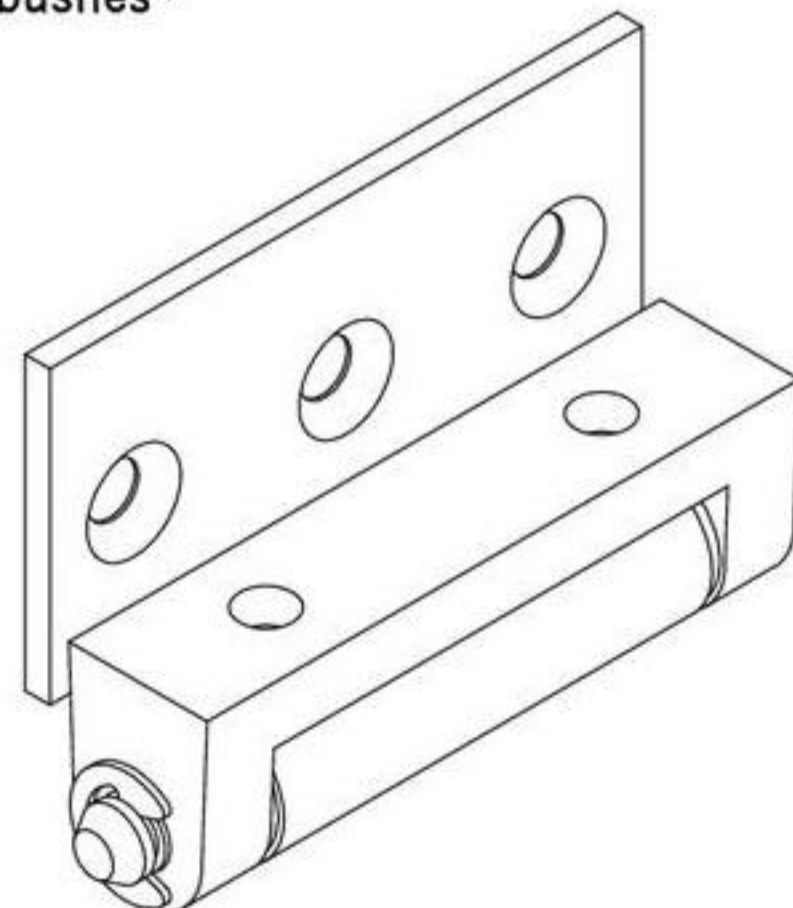
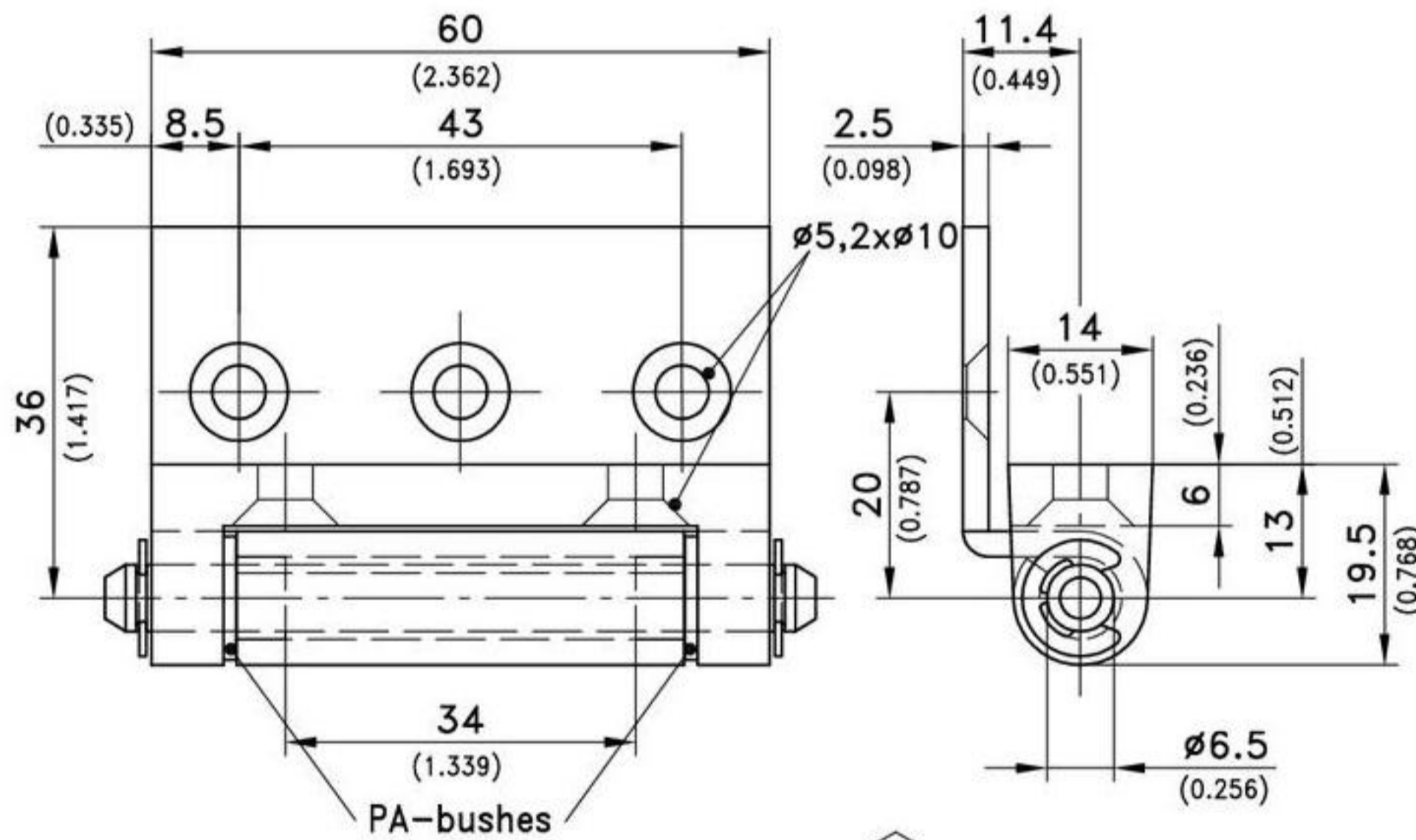
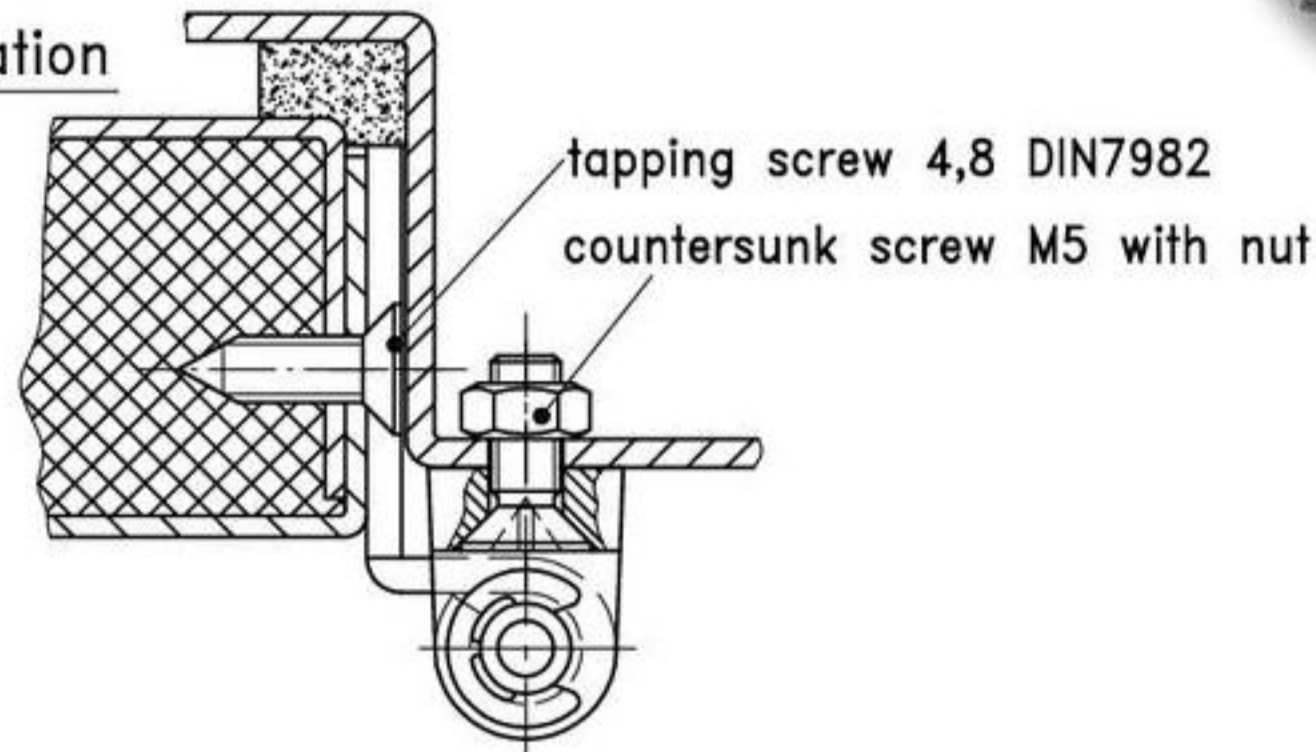

Hinge	Part No.	see page
Countersunk machine screws, zinc plated	217-9501	
		09.5

4-355SL Hinge Pr01 SNAP-LINE 180°

nested door



Hinge SNAP-LINE for flush doors.

- RH and LH application.
- Frame-part with D-SNAP technology.
- Door-part with countersunk holes for screws M5.
- Further details and dimensions see page 06.30.

Material:

- **Hinge Parts:**
zinc die, black
- **loose pin:**
steel, zinc plated
- **fixed pin:**
stainless steel
- **Bushings:**
PA
- **Washers:**
steel, zinc plated
- **Snap wedges:**
sintered metal, plated

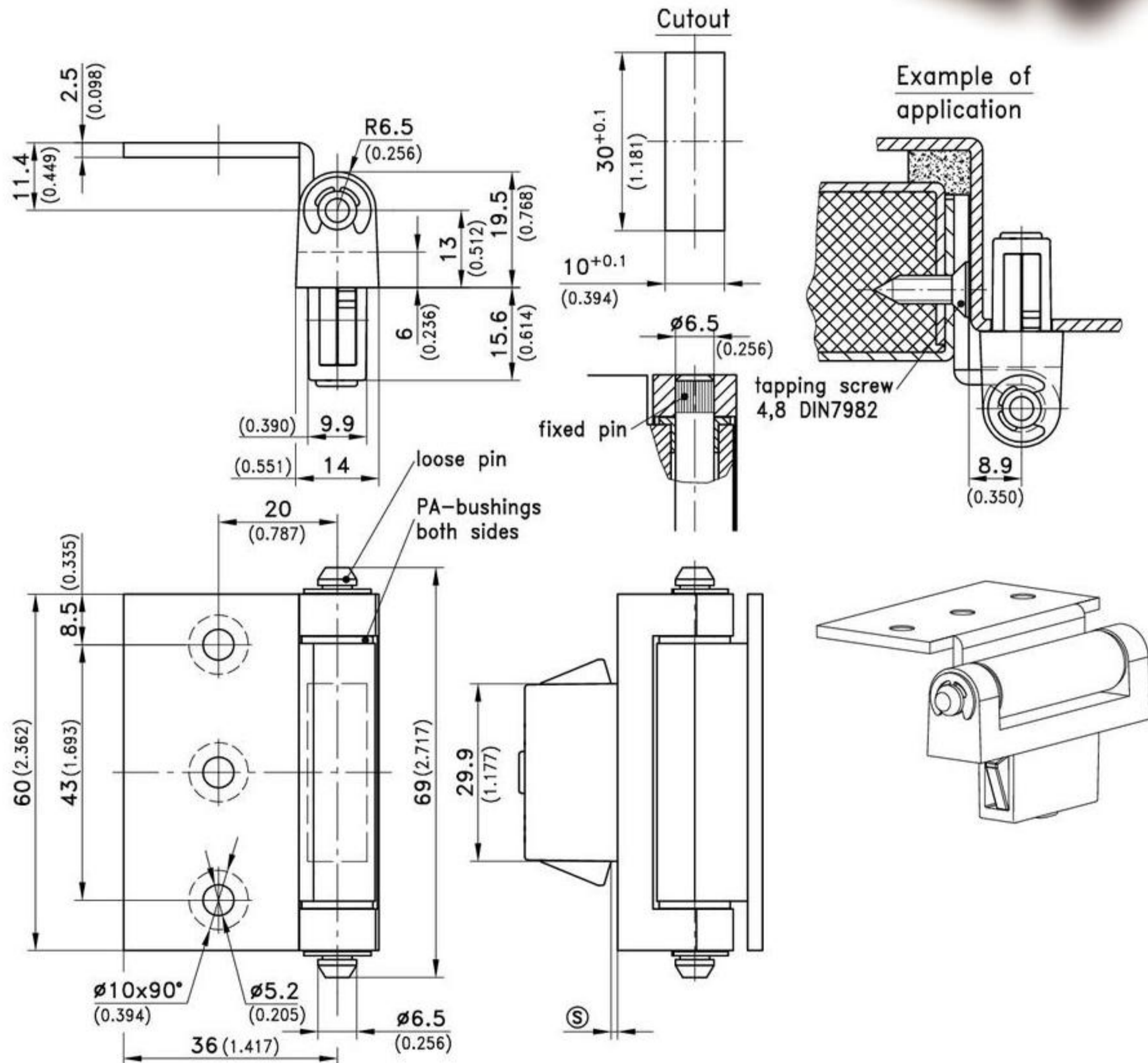

clamping range ©	with loose pin	with fixed pin	see page
1,2 - 1,7	417-9103.00-00015	417-9108.00-00015	
1,7 - 2,2	417-9103.00-00020	417-9108.00-00020	
2,2 - 2,7	417-9103.00-00025	417-9108.00-00025	
2,7 - 3,2	417-9103.00-00030	417-9108.00-00030	
Other © - dimension on request!			
Cover for cutout 30x10	292-0401.00-03010	292-0401.00-03010	01.107
Reinforcement plate for thin-walled sheets and for higher loads:	292-0702.15-01030	292-0702.15-01030	01.108
Tool for uninstallation	292-0306.80-02530	292-0306.80-02530	01.109