

5-131 Window seal

EPDM



Window seals are used to mount panes, windows, etc. in doors, casings and machine enclosures.

- The pane is clamped in place with the help of the filler and held flush-mounted in the cutout.
- The window seal is made of EPDM with excellent weathering and ozone resistance properties.
- DIRAK's EPDM quality is neutral to paints.

• Tolerances: see page 07.7

Material:
 EPDM

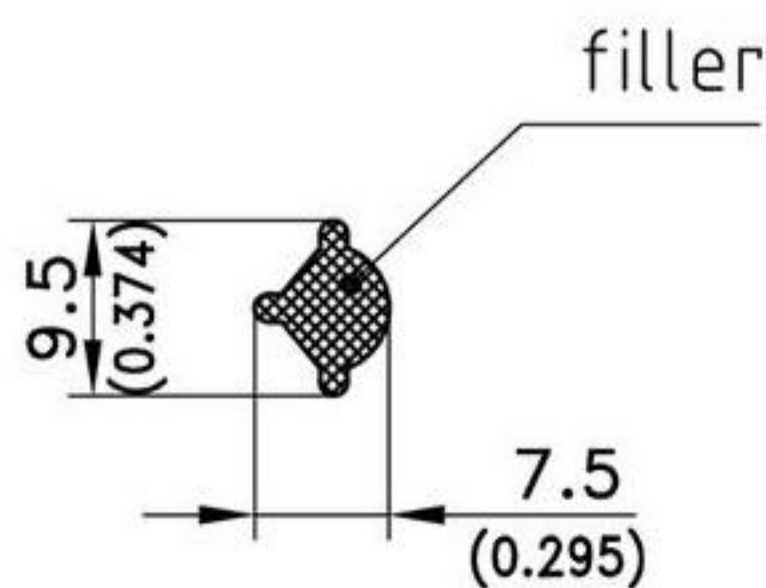
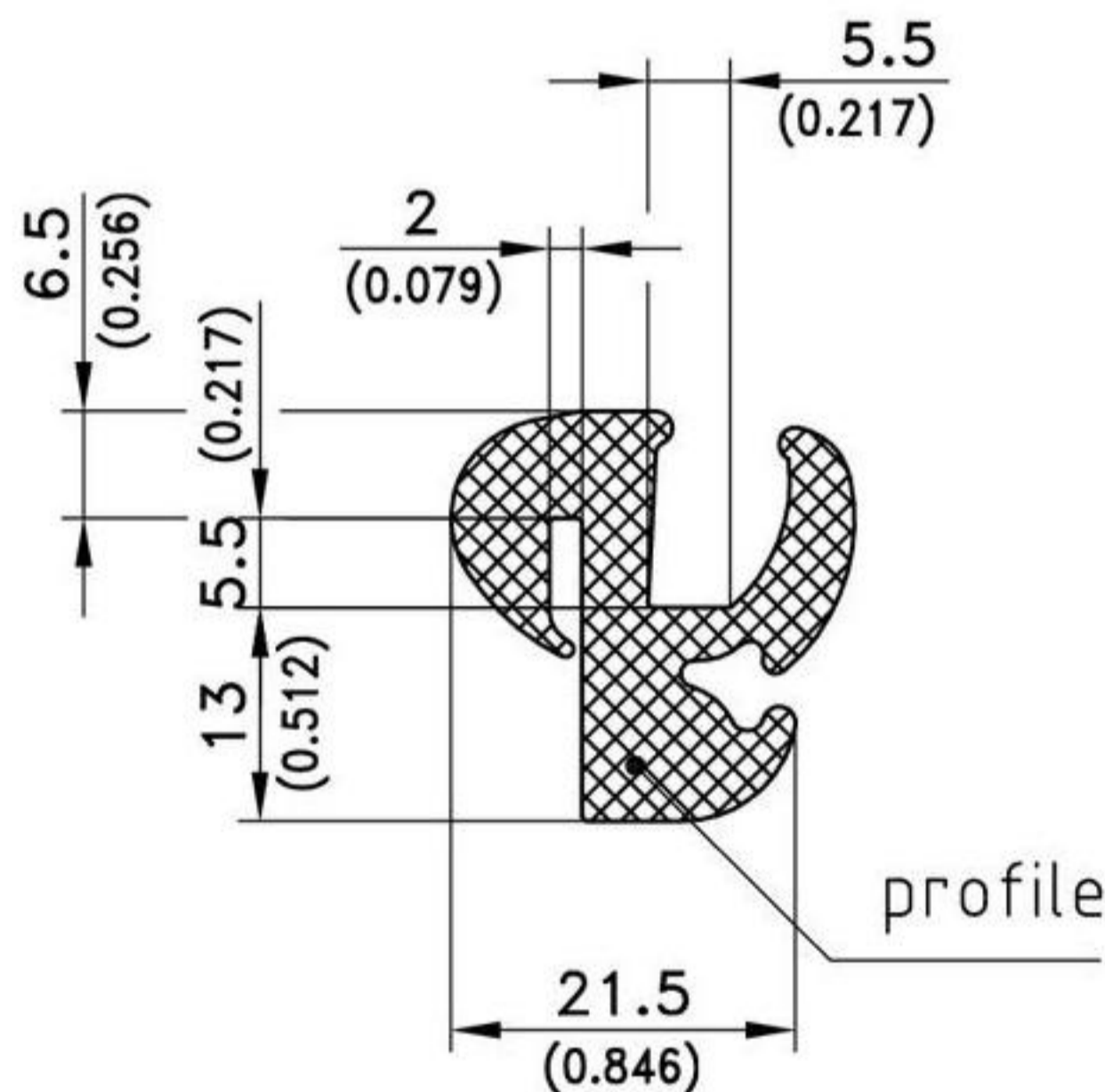

color
 black

packaging unit
 15m

Part No.
 209-0504

Filler Part No.
 209-0602