

7-090 Quarter-Turn with Handle Pr20.1 L18

stainless steel AISI 316

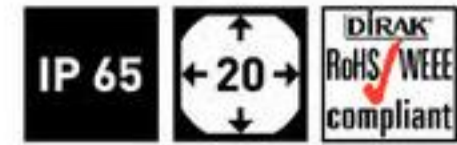

Quarter-Turn with T-Handle.

- RH or LH application.
- Water- and dust-tight according to IP65 DIN EN 60529.
- The Quarter-Turn consists of two basic components which can be combined to suit your application.
- On request parts can be assembled by DIRAK.
- A pre-assembled Quarter-Turn can be installed in the cutout.

Material:

- **T-Handle:**
stainless steel, finish: polished
- **Nut and cam:**
stainless steel

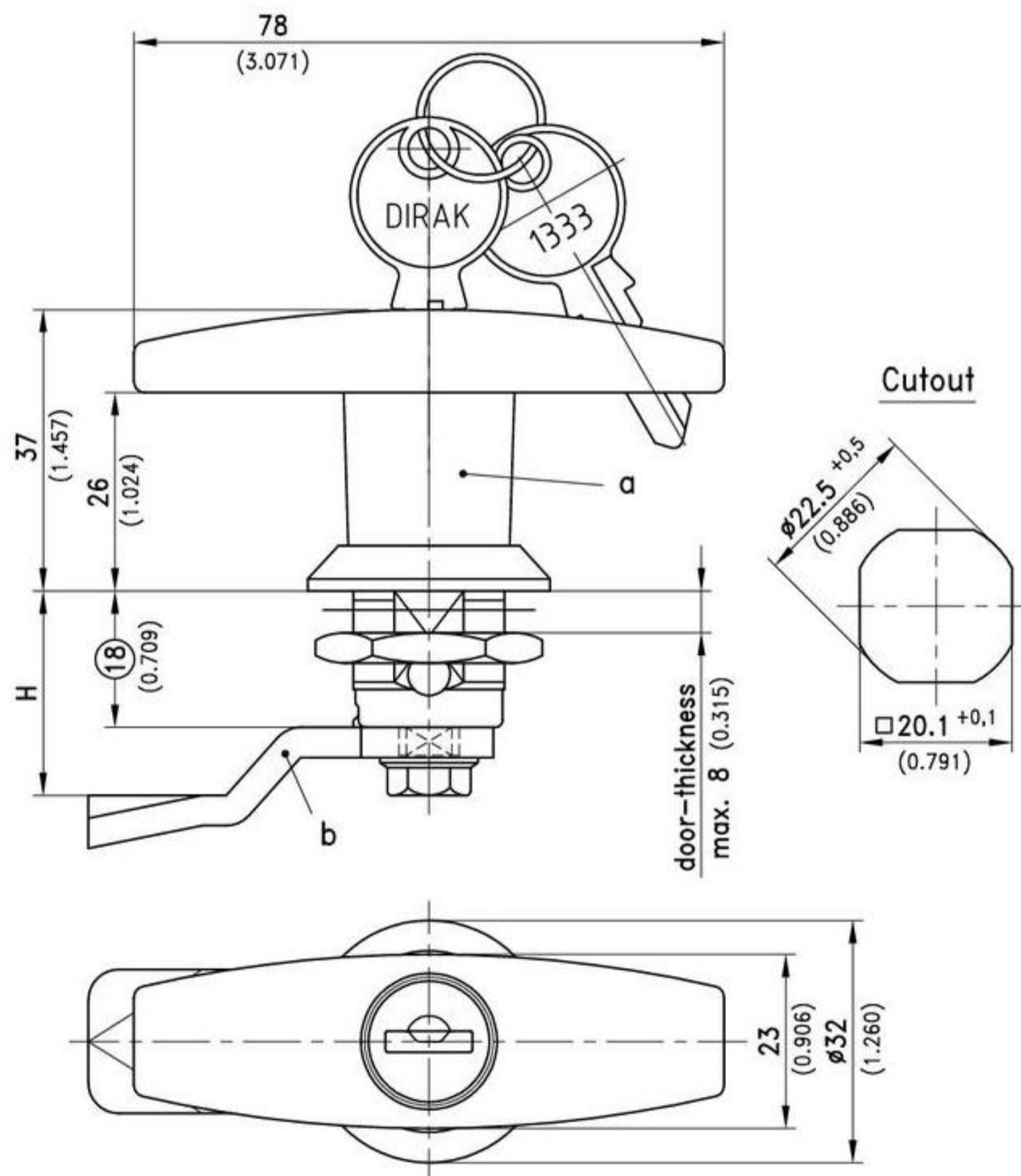

a) T-Handle with standard nut non locking	Part No. 200-9374	see page
keyed alike 1333	200-9398	
keyed different/mixed	200-9399	
b) Cam		10.10, 10.12, 02.58, 02.61
Please order separately:		
c) Assembling cam in line with handle	200-0001	
Assembling cam 90° to handle	200-0019	
All lockable handles supplied with two keys.		