

Spring loaded toggle latches without strike

These latches are used with strike part numbers 16-7-3915 and 16-7-3916 (see below)

A	B	C	note	part number	material	finish	weight
70.8	28.7	10.2		16-7-3910	steel	zinc plated	50g
70.8	28.7	10.2		16-7-3911	304 stainless steel	raw	50g
70.8	28.7	10.2	with seal wire hole	16-7-3920	304 stainless steel	raw	50g

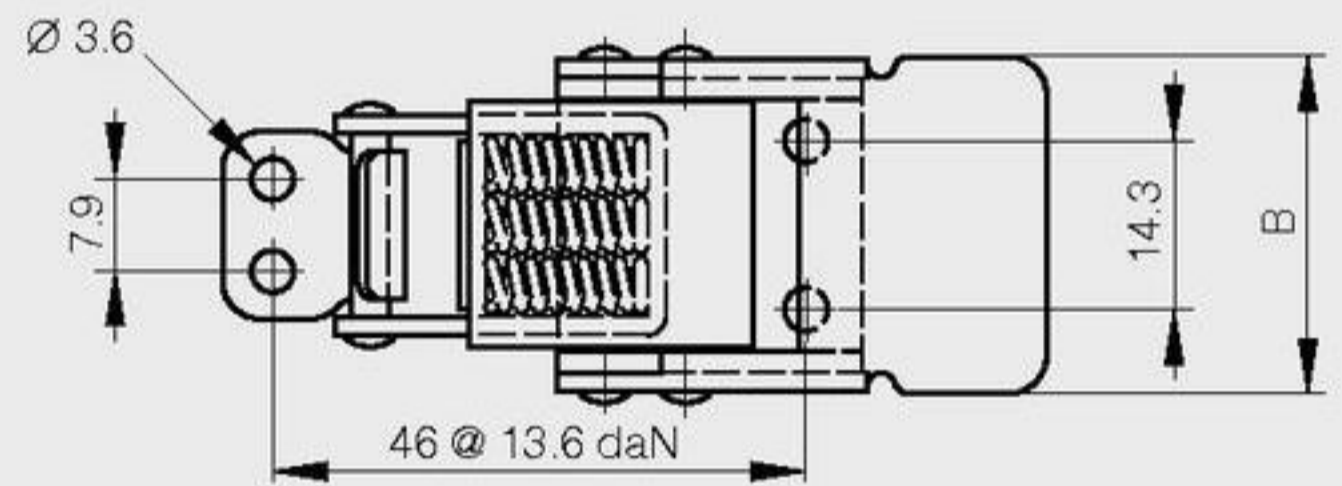
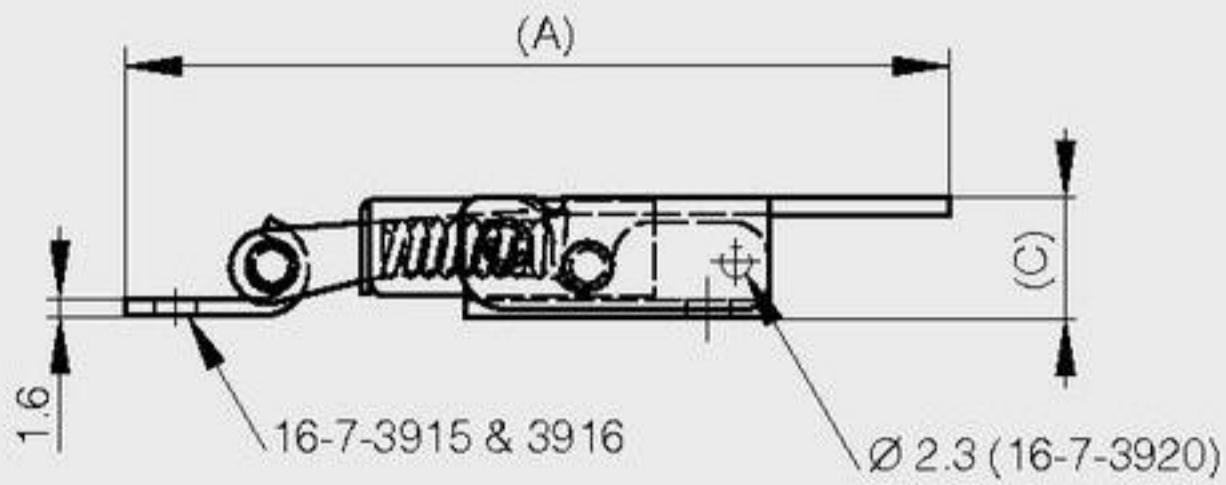

This latch is used with strike part number 16-7-3916 (see below).
 A padlockable option is available for part number 16-7-3917.
 The push button prevents accidental opening.

A	B	C	note	part number	material	finish	weight
70.9	28.7	14.7	with push button to open / no seal wire hole	16-7-3918	304 stainless steel	raw	50g

