

**Square hinges with two offset leaves and removable pin - with 6 holes**

Removable pin

A	B	C	D	F	G	H	S	part number	material	finish	weight
70	70	2	6	8	50	18	4	50-7-3583	steel	zinc plated	156g
80	80	2.5	6	8	60	20.5	4	50-7-3584	steel	zinc plated	164g
70	70	2	6	8	50	18	4.5	52-1-3614	304 stainless steel	raw	156g
80	80	2.5	6	8	60	20.5	4.5	52-1-3616	304 stainless steel	raw	164g

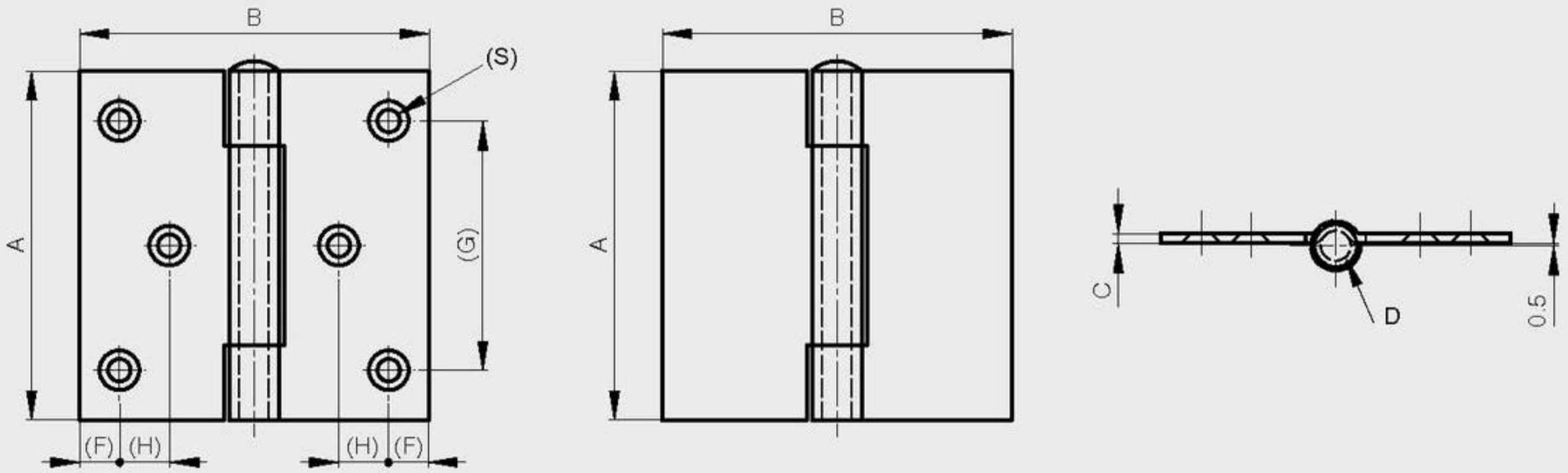

**Square hinges with two offset leaves and riveted pin - with 4 holes**

Riveted pin

A	B	C	D	F	G	S	part number	material	finish	weight
40	40	2	4	8	24	4	52-1-3609	304 stainless steel	raw	34g
50	50	2	6	8	34	4.5	52-1-3611	304 stainless steel	raw	61g
60	60	2	6	8	40	4.5	52-1-3613	304 stainless steel	raw	82g
50	50	2	6	8	34	4.5	52-1-3709	316 stainless steel	raw	61g
40	40	2	4	8	24	4	52-1-3872	316 stainless steel	raw	34g
60	60	2	6	8	40	4.5	52-1-3873	316 stainless steel	raw	82g

