



Buy on-line
at the FA Parkes
sales portal
the quickest
and most efficient
way to purchase
all your hardware
requirements; locks
handles, hinges
stays, gasketing
etc....

www.faparkes.co.uk
your one stop shop!

'FT' Keys
Optional



Single-sided 'FS'
keys are standard



9/00990
Large 'T' with
'easy-fix' mounting

ORDERING CODE

9/00990	Large 'T', locking, chrome
9/00990/01	As above, FS 880 keys
9/00990B	Large 'T', locking, black
9/00990B/01	As above, FS 880
9/00991	Large 'T', non-locking, chrome
9/00991B	Large 'T', non-locking, black

SPECIFICATION

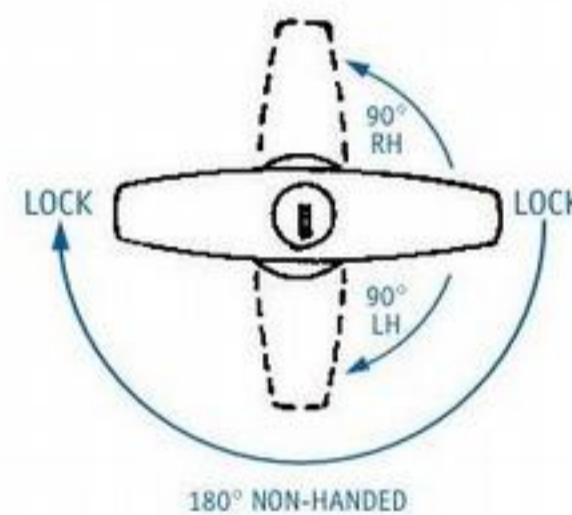
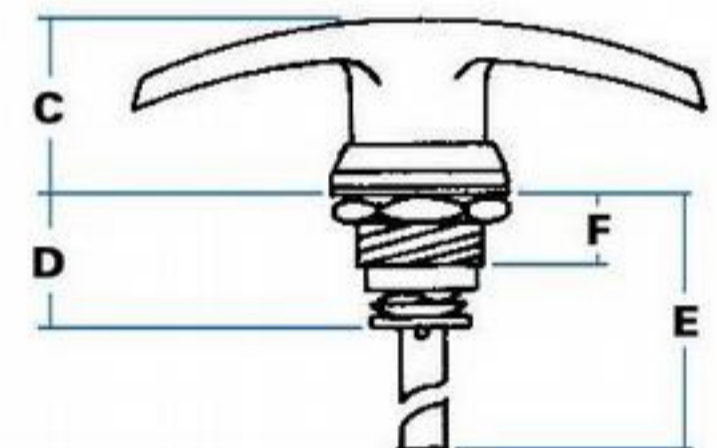
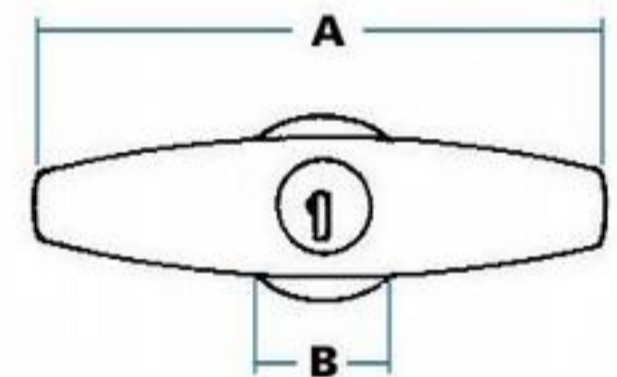

Handles operate through 180° as standard (non-handed), locking in two positions. To special order, rotation can be limited to 90° LH (clockwise) or 90° RH (anticlockwise), when handle will only lock in the rest position. Illustration shows handle with 'flats' vertical on escutcheon.

A	Handle length	100 mm
B	Face width	30 mm
C	Face height	30 mm
D	Body depth	26 mm
E	Total projection (shaft length)	63 mm
F	Depth of thread	15 mm

PANEL-PIERCING DETAIL

This larger aperture also suits our other 'easy-fix' handles, 'Turnbutton' and 'Compact' models.

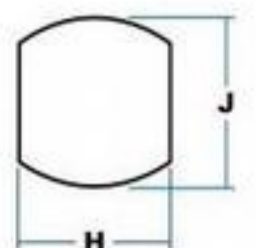

H	Piercing across flats	22 mm
J	Piercing, diameter	24 mm

HANDLE WITH DIECAST CAM (LEFT)

Two sizes of diecast cam are available (32 & 63 mm), which can be adjusted on a (plain) 8 mm shaft, and secured with concealed screw.

Large 'T' with 63mm
diecast cam, (9/00837)



F.A. Parkes (M.B.F) Limited
Unit 4, Acorn Court
Butts Street, Leigh
Lancashire WN7 3AE

Tel. 01942 681 996
sales@faparkes.co.uk