

Buy on-line
at the FA Parkes
sales portal
the quickest
and most efficient
way to purchase
all your hardware
requirements; locks
handles, hinges
stays, gasketing
etc....

www.faparkes.co.uk
your one stop shop!



9/00129
Key

9/00113
'Tri'-lock



9/00629
Key

9/00613
Square-drive
lock

ORDERING CODE

9/00112 'Tri-lock', all-black

9/00113 'Tri-lock', chrome

9/00129 Key for tri-lock, steel

9/00612 Square-drive lock, black

9/00613 Square-drive lock, chrome

9/00629 Key for square-drive lock

7/1905, spiked locating
plate for wooden panels

Panel-piercing
detail

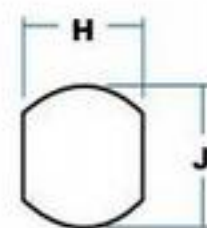
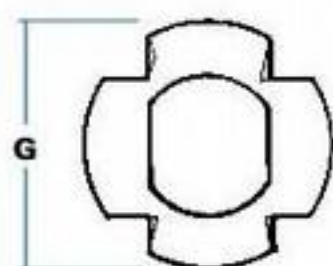

G Diameter, locating plate	34 mm
H Piercing, across flats	17.5 mm
J Piercing, diameter	20 mm
K Special keys, length	62 mm

Locating plate must be ordered separately with this specification. Latch bar reversible, can be fitted at 45° intervals.

SPECIFICATION

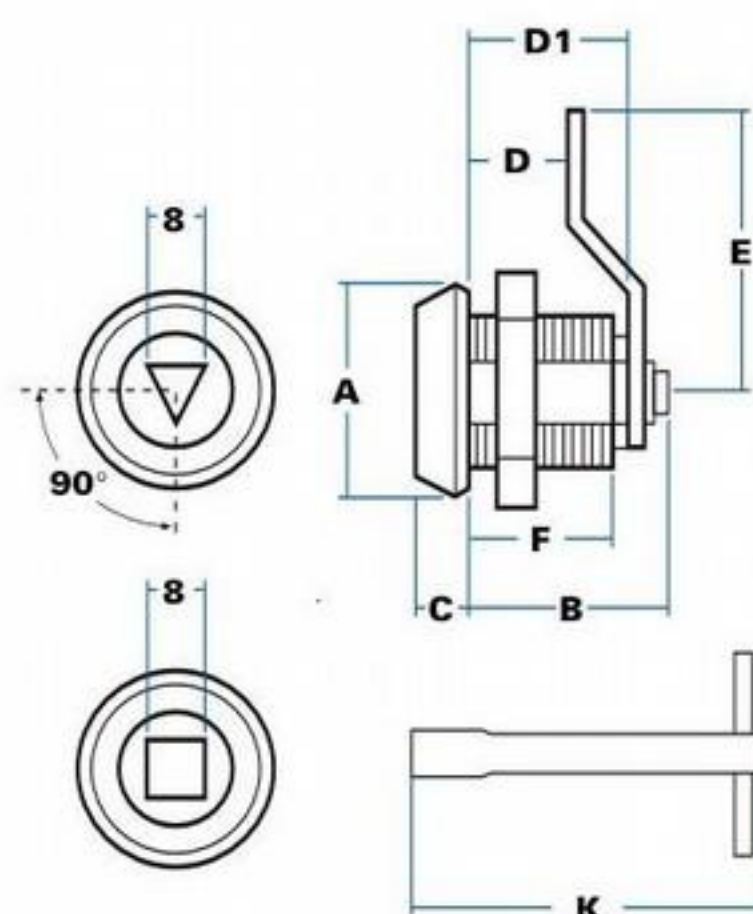

A Head diameter	26 mm
B Total depth	27 mm
C Head projection	6 mm
D Depth to cranked latch	12 mm
D1 Body depth	19 mm
E Height of bar	37 mm
F Thread depth	15 mm

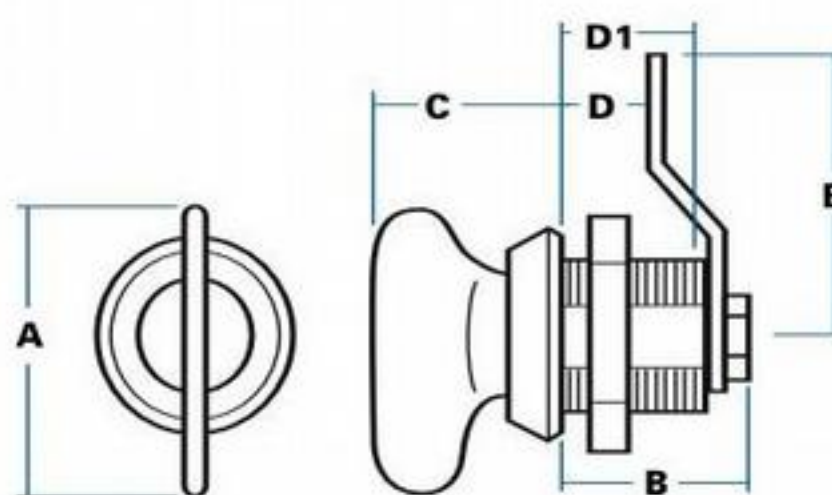

SPECIFICATION

A Height of key	32 mm
B Total depth	20 mm
C Head projection	25 mm
D Depth to cranked latch	6 mm
D1 Body depth	13 mm
E Height of bar	37 mm



9/00123

ORDERING CODE

9/00123 Fixed-key lock, black & chrome.

Locating plate must be ordered separately with this specification.

F.A. Parkes (M.B.F) Limited
Unit 4, Acorn Court
Butts Street, Leigh
Lancashire WN7 3AE

Tel. 01942 681 996
sales@faparkes.co.uk