

'T' key 1/24596
(90mm)

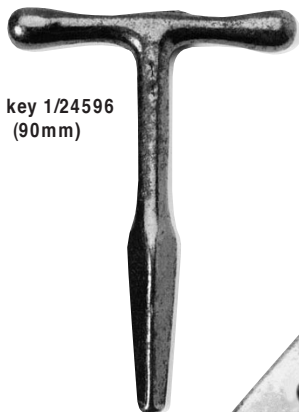

'T' key
1/24597
(125mm)

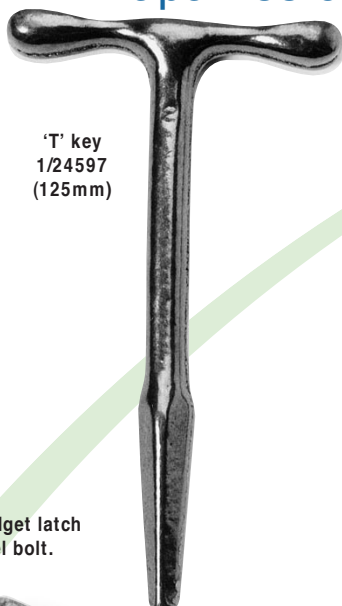

3/09656 Budget latch
with steel bolt.

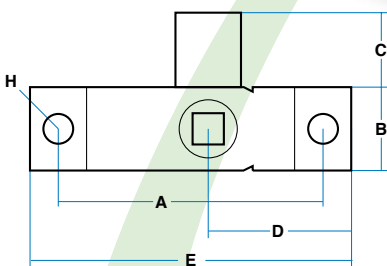
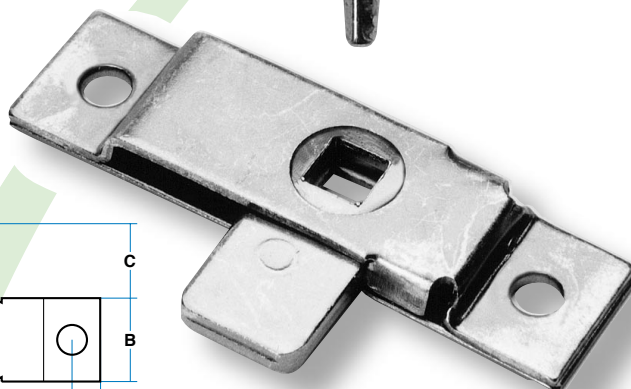

SPECIFICATION

A	Hole Centres	66 mm
B	Case Width	22 mm
C	Bolt Protection	18 mm
D	Location	38 mm
E	Case Length	85 mm
F	Thickness	10 mm
H	Hole Size Diameter	7 mm

ORDERING CODE

1/24596	'T' Key 90 mm length
1/24597	'T' Key 125 mm length
3/09656	Universal budget latch - steel
3/09282	Universal budget latch - moulded bolt
3/09656SS	Universal budget latch - stainless steel

'UNIVERSAL' BUDGET LATCH & FITTINGS

This simple 'deadbolt' latch has become an industry standard. Basic model is mild steel construction, with options in stainless steel or with moulded bolt. Two sizes of operating keys are available and diecast escutcheon covers can be fitted to conceal panel aperture.



Simple 'deadbolt' latch operated by 8mm square follow-bush.



Non-handed design, with bolt able to travel 180° through case but held positively in open and closed positions by concealed spring.



Bolts or rivets through fixing holes through top & bottom plates



Yellow zinc plated throughout, with mild steel models.



Moulded nylon bolt (black) as option with mild steel model. All-stainless latch for corrosion resistance (food industry, etc.).

T-Keys are in malleable iron, burnished & lacquered, and suit all 8mm square follow-bushes.

7/27900
2-hole cover



ORDERING CODE

7/27900	Escutcheon Cover 2-hole, chrome
---------	---------------------------------

SPECIFICATION

A	Length	32 mm
B	Height (max.)	8 mm
C	Width	28 mm
D	Diameter	13 mm
E	Hole Centres	20 mm
F	Hole Centres	15 mm
H	Hole Sizes, c/s 5mm	3 mm

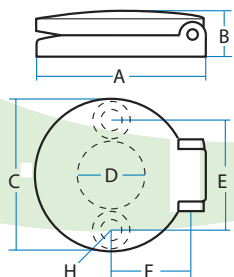

DIECAST 2-HOLE ESCUTCHEON COVER

Simple 'snap-shut' covers to protect external panel aperture. Waterproof, opens to 110° for easy fitting with spring return.